

Quick Guide

Inläring av trådlös termostat / Programming wireless thermostat



1 Anslut ställdonen i den nedre av de två plintraderna märkt 1-8. OBS! Inte i den övre plintraden märkt 1-8.

Connect the actuators to the bottom row of terminal plugs marked 1-8. Note! Not in the row marked 1-8.



2 Strömsätt mottagarenheten.

Plug in the receiver unit.

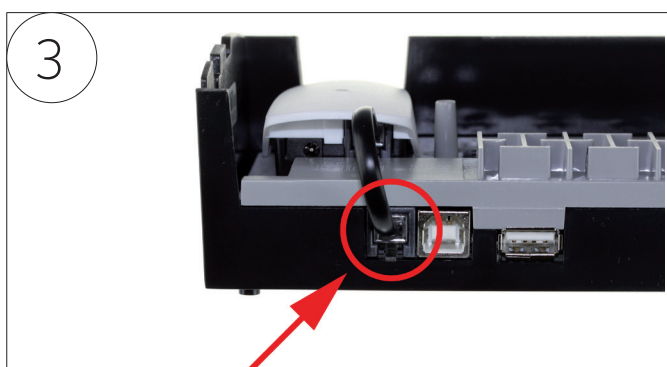

3 Kontrollera att radiolänken är ansluten till mottagarenheten.

Make sure that the radio link is connected to the receiver unit.

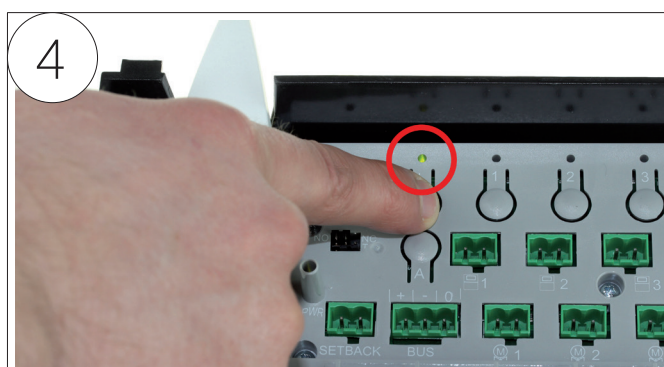

4 Tryck i L-knappen under minst tre sekunder tills L-LED lyser grönt.

Press the L-key for at least three seconds until L-LED lights up green.



5 Ta bort termostatsens bakstycke genom att trycka in låsningen med hjälp av skruvmejsel eller motsvarande.

Remove the back of the thermostat by pressing the locking with a screwdriver or similar.

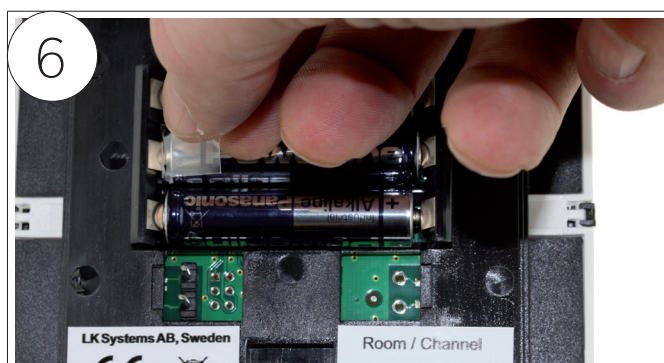

6 Ta bort plastbiten från termostatsens batteri.

Remove the plastic from the battery of the thermostat.

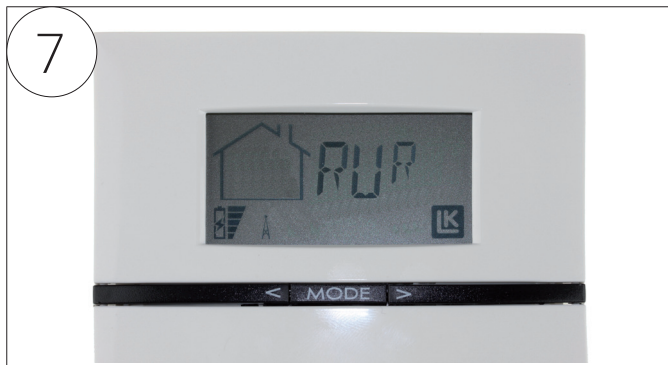

Termostaten visar *RUR*.

The thermostat shows *RUR*.

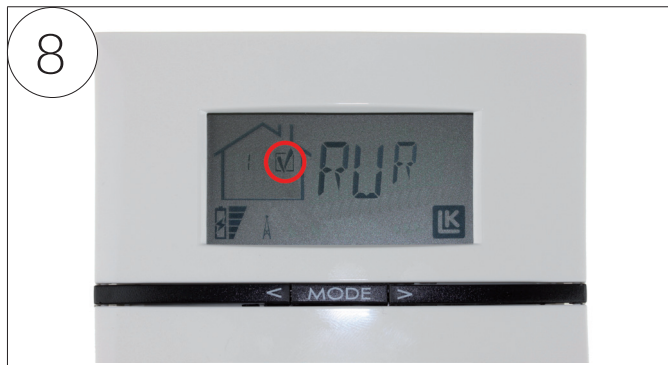

Tryck in *Mode* på termostaten tills "bocken" visas i displayen.

Press *Mode* on the thermostat until the "checkmark" is shown in the display.



Mottagarenhetens L-LED lyser gul och valbara kanaler lyser grönt. Välj kanaler genom att trycka på önskade kanaler. Valda kanaler blinkar grönt.

The receiver unit's L-LED switches to yellow and selectable channels light up green. Select channel by pressing desired channel key. The selected channel flashes green.

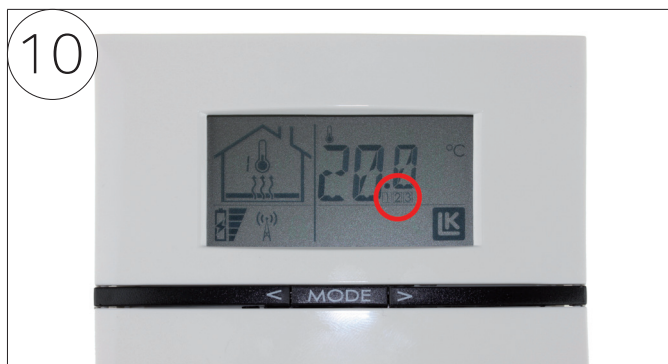

Kontrollera att valda kanaler visas i termostaten. Bekräfta med *Mode*. Termostaten växlar till normalvy.

Check that the selected channels are shown in the display. Confirm with *Mode*. The thermostat switches to normal view.

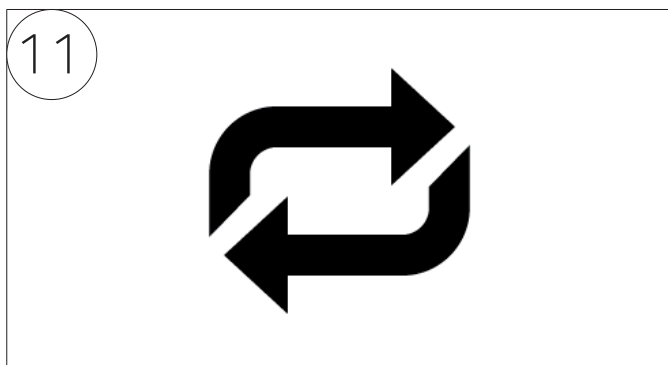

Upprepa steg 5-10 för övriga termostater i anläggningen.

Repeat steps 5-10 for the other thermostats in the facility.



Avsluta inläringen genom att trycka på L-knappen varpå L-LED slocknar.

Complete the programming by pressing the L-key whereupon the L-LED goes out.

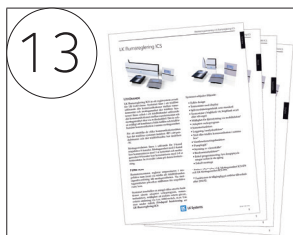

13

Inläringen av termostaterna är nu klar. För en mer utförlig monteringsanvisning, se bipackad monteringsanvisning eller www.lksystems.se.

The programming of the thermostats is now completed. For a more detailed assembly instruction, see supplied instructions or www.lksystems.se.